

# M.M. REDUCING MALE NIPPLE, E0245

## FEATURES

- Conform to DZR brass, CW602N
- These fittings have excellent high temperature ductility.
- They are excellent in corrosion resistance.

## THREADS

All fittings are in ISO 7/1 (BSPT) threads - Standard

### -Options

ISO 228/1 (BSPP) threads

ANSI/ASME B1.20.1 (NPT) threads

SIZE (inches)	PN (bar)
1/8-1	40
1¼-2	25
2½-4	16

## APPLICATIONS

Drinking Water, Turbulent/Stagnant Water, Turbulent/Stagnant Sea Water

## PRESSURE & TEMPERATURE

The range of the temperature of use goes from -10°C to 200°C, whereas the pressure of use (in bar) as regards to the temperature of the fluid are:

Temperature °C	PN16	PN25	PN40
From -10 to 66	16	25	40
100	16	25	40
120	13.5	21.8	36
150	9.5	16.5	30
170	7	12.8	26
180	-	11.3	24
186	-	10.5	22.8
198	-	-	20.4
200	-	-	20

## M.M. REDUCING MALE NIPPLE - E0245



Dimensions in: mm

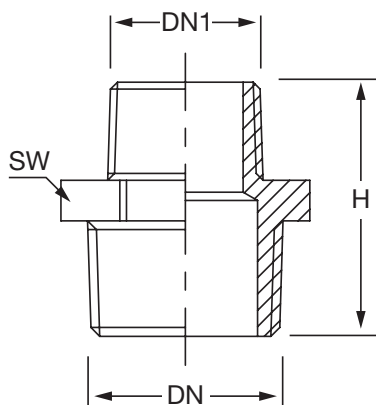

DN	DN1	H	SW	DN	DN1	H	SW
1/4"	1/8"	27.5	15	1¼"	1"	51.5	50
3/8"	1/8"	28	20	1½"	1/2"	49.5	55
3/8"	1/4"	31	20	1½"	3/4"	50	56
1/2"	1/8"	31.5	24	1½"	1"	52	55
1/2"	1/4"	33.5	24	1½"	1¼"	54.5	55
1/2"	3/8"	35	24	2"	1/2"	53.5	68
3/4"	1/8"	36	28	2"	3/4"	54	68
3/4"	1/4"	36.5	28	2"	1"	57	68
3/4"	3/8"	37	28	2"	1¼"	58.5	68
3/4"	1/2"	38	28	2"	1½"	58.5	68
1"	1/4"	41	38	2½"	1¼"	52.5	82
1"	3/8"	41	38	2½"	1½"	57	82
1"	1/2"	43.5	38	2½"	2"	65.5	82
1"	3/4"	43	38	3"	2"	63	96
1¼"	1/2"	50	50	3"	2½"	67.5	94
1¼"	3/4"	48	48	4"	3"	88	120