

FEMALE COUPLING E0270

FEATURES

- Conform to DZR brass, CW602N
- These fittings have excellent high temperature ductility.
- They are excellent in corrosion resistance.

THREADS

All fittings are in ISO 7/1 (BSPT) threads - Standard

-Options

ISO 228/1 (BSPP) threads

ANSI/ASME B1.20.1 (NPT) threads.

| SIZE (inches) | PN (bar) |
|---------------|----------|
| 1/8-1 | 40 |
| 1¼-2 | 25 |
| 2½-4 | 16 |

APPLICATIONS

Drinking Water, Turbulent/Stagnant Water, Turbulent/Stagnant Sea Water

PRESSURE & TEMPERATURE

The range of the temperature of use goes from -10°C to 200°C, whereas the pressure of use (in bar) as regards to the temperature of the fluid are:

| Temperature °C | PN16 | PN25 | PN40 |
|----------------|------|------|------|
| From -10 to 66 | 16 | 25 | 40 |
| 100 | 16 | 25 | 40 |
| 120 | 13.5 | 21.8 | 36 |
| 150 | 9.5 | 16.5 | 30 |
| 170 | 7 | 12.8 | 26 |
| 180 | - | 11.3 | 24 |
| 186 | - | 10.5 | 22.8 |
| 198 | - | - | 20.4 |
| 200 | - | - | 20 |

FEMALE COUPLING - E0270

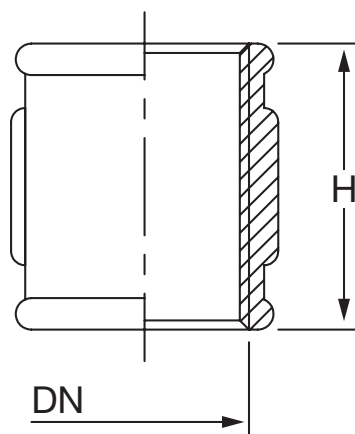

Dimensions in: mm

| DN | H |
|------|------|
| 1/8" | 23.5 |
| 1/4" | 25 |
| 3/8" | 29 |
| 1/2" | 33.5 |
| 3/4" | 35.5 |
| 1" | 45.5 |
| 1¼" | 47 |
| 1½" | 53 |
| 2" | 63.5 |
| 2½" | 72.5 |
| 3" | 78 |
| 4" | 91.5 |