

# DOUBLE SCREW MALE NIPPLE, E0280

## FEATURES

- Conform to DZR brass, CW602N
- These fittings have excellent high temperature ductility.
- They are excellent in corrosion resistance.

## THREADS

All fittings are in ISO 7/1 (BSPT) threads - **Standard**

### -Options

ISO 228/1 (BSPP) threads

ANSI/ASME B1.20.1 (NPT) threads.

SIZE (inches)	PN (bar)
1/8-1	40
1¼-2	25
2½-4	16

## APPLICATIONS

Drinking Water, Turbulent/Stagnant Water, Turbulent/Stagnant Sea Water

## PRESSURE & TEMPERATURE

The range of the temperature of use goes from -10°C to 200°C, whereas the pressure of use (in bar) as regards to the temperature of the fluid are:

Temperature °C	PN16	PN25	PN40
From -10 to 66	16	25	40
100	16	25	40
120	13.5	21.8	36
150	9.5	16.5	30
170	7	12.8	26
180	-	11.3	24
186	-	10.5	22.8
198	-	-	20.4
200	-	-	20

## DOUBLE SCREW MALE NIPPLE - E0280

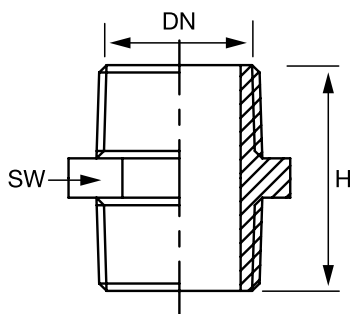

Dimensions in: mm

DN	H	SW
1/8"	25	14
1/4"	29	17
3/8"	34.5	20
1/2"	38	24
3/4"	41	29
1"	46	38
1¼"	55	50
1½"	54.5	55
2"	64	67
2½"	72	81
3"	80.5	97
4"	93.5	119